



SEYON
REALTORS

SHWARNA POOMI

HOUSE OF PURE DIVINE AND EXQUISITE



SHWARNA POOMI

HOUSE OF PURE DIVINE AND EXQUISITE

" Shwarna poomi located in the serene surrounding of Mathampalayam , with 100 luxurious villas 3bhk and 2bhk villas is sprawled over 3.6 acres of land embraced by rolling hills and lush verdure. every villa is masterfully designed and intricately crafted using superior materials and fitted with sumptuous comforts all making it a perfect abode for the discerning."



Each Villa offers breathtaking views of the surroundings landscape, creating a sense of tranquility. A gated community with like-minded individuals ensure privacy, security, and a sense of belonging. Proximity to nature reserves, parks and outdoor recreational areas provides endless opportunities for exploration and connection with nature.



SHWARNA POOMI
HOUSE OF PURE DIVINE AND EXQUISITE

PHASE-I		SITE NO:	AREA (CENTS)	SITE NO:	AREA (CENTS)	SITE NO:	AREA (CENTS)	SITE NO:	AREA (CENTS)
			8	3.30	17	3.44	26	3.09	35
	9	3.44	18	3.16	27	4.86	36	3.44	
1	3.42	10	4.47	19	3.39	28	5.31	37	3.44
2	3.30	11	3.44	20	2.94	29	3.44	38	3.44
3	3.30	12	3.44	21	2.53	30	3.44	39	3.97
4	3.30	13	3.44	22	3.09	31	3.44	40	6.55
5	3.30	14	3.44	23	3.09	32	3.34	41	5.79
6	3.30	15	3.44	24	3.09	33	3.56	42	4.45
7	3.30	16	3.44	25	3.09	34	3.66	43	3.45

SITE NO:	AREA (CENTS)	SITE NO:	AREA (CENTS)	SITE NO:	AREA (CENTS)
1	2.27	10	2.80	19	3.66
2	2.61	11	2.75	20	4.14
3	2.60	12	2.75	21	2.53
4	2.75	13	3.43	22	2.75
5	3.44	14	3.78	23	2.75
6	3.03	15	2.75	24	2.75
7	3.15	16	2.75	25	2.75
8	2.75	17	3.00	26	2.75
9	2.90	18	3.71	27	2.75
PHASE-II				28	2.75
				29	4.20



SHWARNA POOMI
HOUSE OF PURE DIVINE AND EXQUISITE



7.2 M LAYOUT ROAD

35'6"	37'6"	36'	36'6"	29'3"	25'6"	36'
33'0"	37'6"	36'	36'6"	29'3"	25'6"	36'
35'6"	37'6"	36'	36'6"	29'3"	25'6"	36'
33'0"	37'6"	36'	36'6"	29'3"	25'6"	36'

9M LAYOUT ROAD PHASE-2

28'9"	30'0"	30'9"	30'0"	30'0"	30'9"	30'0"
40'	30'	30'	30'	30'	30'	30'
40'	30'	30'	30'	30'	30'	30'
40'	30'	30'	30'	30'	30'	30'

7.2 M LAYOUT ROAD

45'0"	46'3"	32'	45'0"	45'0"	45'0"	45'0"
40'	32'	32'	45'0"	45'0"	45'0"	45'0"
40'	32'	32'	45'0"	45'0"	45'0"	45'0"
40'	32'	32'	45'0"	45'0"	45'0"	45'0"

7.2 M LAYOUT ROAD PHASE-1

38'5"	43'10"	29'1"	38'5"	43'10"	29'1"	38'5"
30'	30'	30'	30'	30'	30'	30'
30'	30'	30'	30'	30'	30'	30'
30'	30'	30'	30'	30'	30'	30'

9M LAYOUT ROAD

52'2"	30'	30'	30'	30'	30'	30'
50'	50'	50'	50'	50'	50'	50'
50'	50'	50'	50'	50'	50'	50'
50'	50'	50'	50'	50'	50'	50'

7.2 M LAYOUT ROAD

43'3"	43'3"	43'3"	43'3"	43'3"	43'3"	43'3"
30'	30'	30'	30'	30'	30'	30'
30'	30'	30'	30'	30'	30'	30'
30'	30'	30'	30'	30'	30'	30'



SHWARNA POOMI
HOUSE OF PURE DIVINE AND EXQUISITE



SHWARNA POOMI

HOUSE OF PURE DIVINE AND EXQUISITE



LAYOUT ROAD

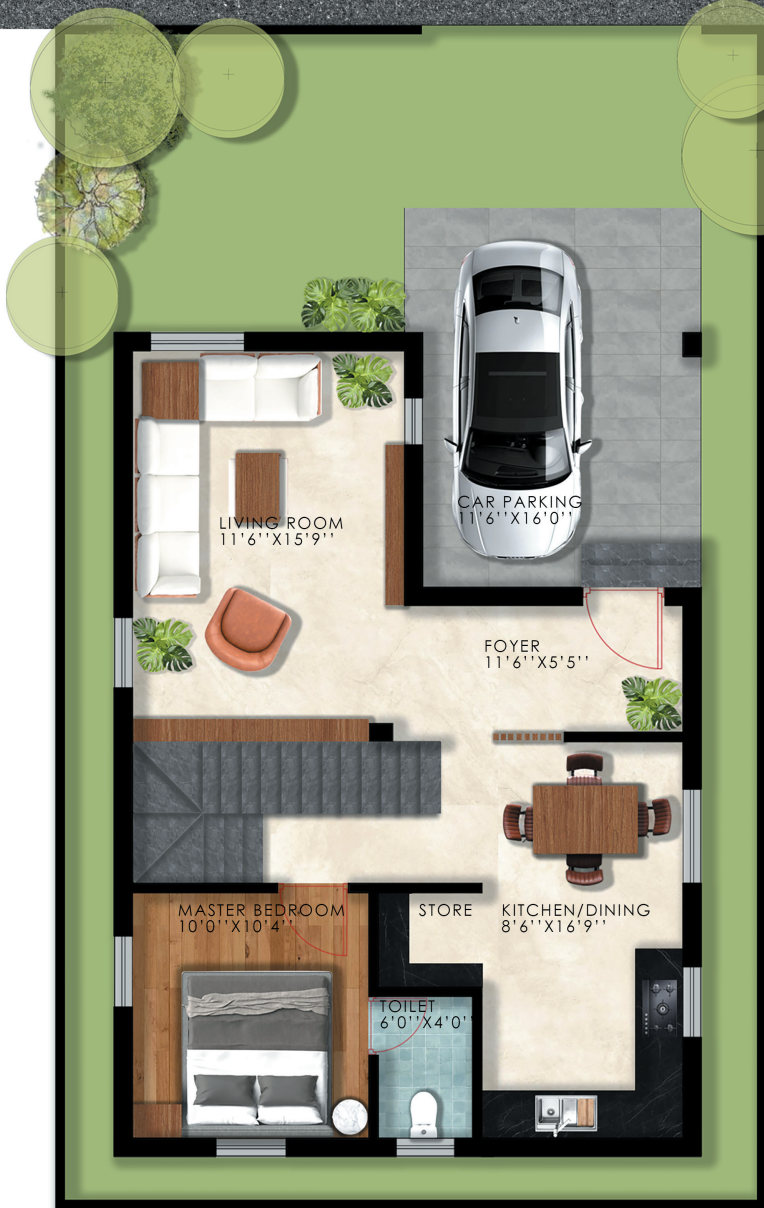

GROUND FLOOR PLAN



FIRST FLOOR PLAN



PLAN FOR SITES- P-I 10-17,28-31,40-43P-II 3,4,5,10-13,21-29
 GROUND FLOOR: 928 SQ.FT FIRST FLOOR: 451 SQ.FT TOTAL BUILT UP AREA.: 1381 SQ.FT



SHWARNA POOMI
 HOUSE OF PURE DIVINE AND EXQUISITE



GROUND FLOOR PLAN



FIRST FLOOR PLAN



PLAN FOR SITES- P-I, 1-9 20-27 34-39 P-II 1-2 ,8,9 ,14-20
 GROUND FLOOR: 902 SQ.FT FIRST FLOOR: 442 SQ.FT TOTAL BUILT UP AREA.: 1344 SQ.FT



SHWARNA POOMI
 HOUSE OF PURE DIVINE AND EXQUISITE

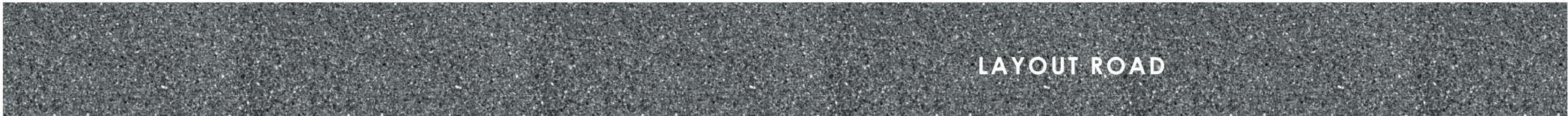

LAYOUT ROAD



PLAN FOR SITES- P-II 18,19 ,32,33,34
GROUND FLOOR: 1000 SQ.FT TOTAL BUILT UP AREA.: 1000 SQ.FT



SHWARNA POOMI
HOUSE OF PURE DIVINE AND EXQUISITE

SPECIFICATIONS

STRUCTURE:

FULL FRAME STRUCTURE

SAND:

M SAND, P SAND

PLUMBING PIPES:

KAVERY

ELECTRICAL WIRES:

FINOLEX ,KUNDAN

TANK:

KAVERI TRIPLE LAYER

PAINT:

ASIAN PAINTS

CEMENT:

CHETTINAD

BRICKS:

SOLID BLOCK

ELECTRICAL PIPES:

VASAVI

SWITCHES & FITTINGS:

GM

TMT:

ISO 9001 CERTIFIED

WINDOWS:

HIGH PROFILE UPVC

SANITARY FITTINGS:

PARRYWARE,HINDWARE

TILES

DOUBLE VITRIFIED



SEYON

REALTORS

CALL 96299 28854

CORPORATE OFFICE ADDRESS:

Srinivasa Residency, SMT Nagar opp, Thudiyalur- Kanuvai Road, Appanaikenpalayam, Pannimadai -641017.

METTUPALAYAM ROAD OFFICE:

Back side Udpiruchi Hotel ,Mettupalayam Road, Mathampalayam-614019.